

## Frequency Controlled Direct Drive Fans FCDDC 241-241 (9/9)

### Technical Data

Supply (V/Ph/Hz)	230 / 1 / 50
Max Airflow (m³/h)	3281
Max Current (A)	6.3
Max Input Power (W)	971
Max Speed (rpm)	1872
ErP Efficiency Rating (FMEG)	46
Ip Rating	44
Motor Insulation Class	F
Temperature Range (°C)	-20 to +40
Weight (KG)	18

### Performance Data

Data Point	Static Pressure (pa)	Airflow (m³/h)	Current (A)	Speed (rpm)	Power (W)
1	670	404	2.8	1872	502
2	503	1767	5.1	1724	859
3	391	2394	5.9	1544	893
4	129	3281	6.3	1217	945
5	32	3119	4.0	990	570

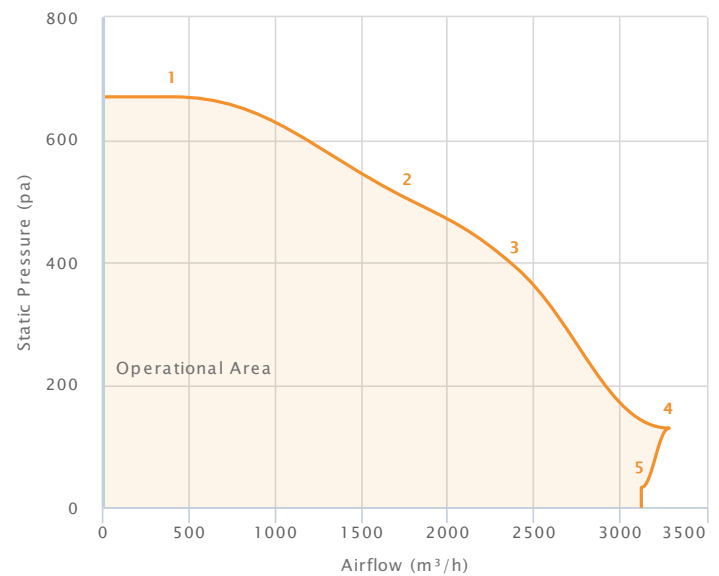

- Tested in accordance with ISO 5801
- Installation type method - type A

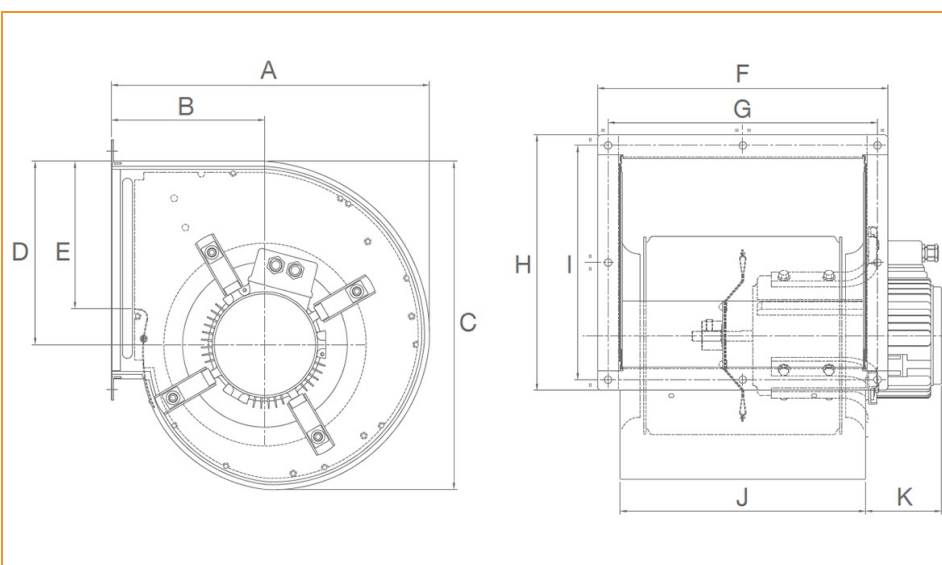

### Dimensions

A	380.9	G	328
B	184.1	H	311
C	392	I	285
D	218.9	J	299
E	176	K	92
F	354	L	